

#20

A classic wood wash

This technique is the perfect start for newbies – follow the steps and create a charming effect.

By Joe Strydom
Photographs
Elza Cooper and
Joe Strydom
Styling Amanda van
Wynngaardt

EASY



QUICK
PROJECT GUIDE
Hard labour 2/10
Skill level 2/10
Time needed 2 hours

You will need



SHOPPING LIST

- Annie Sloan Chalk Paint in French Linen
- Annie Sloan Wax Clear
- Gripseal Resilience Matt
- Annie Sloan Chalk Paint Lacquer Matt

TOOLS

- paintbrush
- sandpaper/electric sander
- buff cloth

Get started...

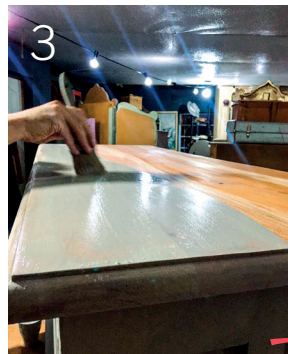

1 Sand the top of your piece with an electric sander; you can also use paint stripper to remove the varnish. Apply two coats of paint in the colour of your choice on the base of your piece; we used Annie Sloan French Linen. Do not paint the top.

2 Seal the raw wood top with Gripseal Resilience Matt.

Dilute the sealant with water (1:1). Make sure the sealant is dry before you start painting using a paintbrush.

3 Dilute your paint with water (1:1). Paint the top, wiping off any excess. Once the paint wash is dry, seal it with Gripseal Resilience Matt. Seal the base of your piece with either Annie Sloan Clear Wax or Lacquer Matt. 🏠



Rug from
Mr Price Home;
accessories
from Trouvé

